

* All images in this datasheet are for illustrative purposes only and may differ from the actual product.



LG LED All-in-One LAED Series

21:9 All-in-One LED Display

1 ALL IN
All-in-One LED Screen

21:9
21:9 Screen Aspect Ratio

D
Dedicated Accessories

⌚
Easy Installation Quick Maintenance

LAED015

Screen Size	171 (434.34 cm)
Pixel Pitch	1.56 mm
Brightness	500 nit
Screen Resolution	2,560 × 1,080
Serviceability	Front
Speaker	Built-in
Controller	Embedded



21:9 Widescreen

With support for a 21:9 widescreen aspect ratio (2,560 × 1,080), LAED series provides an immersive viewing experience with the wider screen than 16:9 display. Its screen specialization helps display 21:9 content including widescreen videoconferencing platforms with the natural details.



All-in-One LED Screen with Built-in Speaker

LG's LED All-in-One LAED series with 171 screen size is offered as an all-in-one package including an embedded controller and built-in speaker. Eliminating the prejudice that LED displays are difficult and complex to install, it doesn't require controller connections or module configuration. After a simple installation process, all you need to do is to turn on the screen with a remote control like home TV.



Quick Maintenance

In case of failure related to the LED module or the system board, it can be serviced from the front. The LED module can be simply detached by the provided magnetic tool and replaced quickly without cabling.

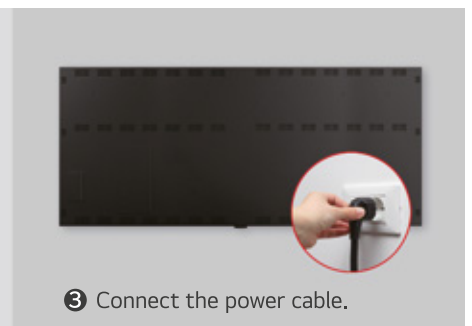
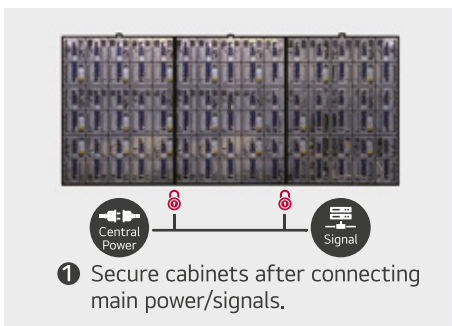

Easy Installation

The installation process of the 21:9 All-in-One series is simple. After securing three cabinets, attach each LED display module to them. Lastly, plug in the power cable. This simple installation saves time and labor, thereby making users handle the LED screen with ease.

* One AC cable for 220VAC, Two for 110VAC

* Fixing screws or installing wall mount/accessories is needed additionally.



Office Meeting Mode

With Office Meeting Mode, easily configure meeting room details like the room number and current time. It also includes convenient features like automatic input switching, a presentation timer, and adjustable settings such as auto-brightness and picture mode.

* Users can enable Office Meeting Mode at EZ Setting menu of the Signage.



Compatible with AV Control Systems

The LAED series supports Crestron Connected®* for high compatibility with professional AV controls to achieve seamless integration and automated control**, boosting business management efficiency.

* Initial setting from display is required for Crestron Connected® compatibility.

** Network based control

*** Crestron Connected® needs to be purchased separately.

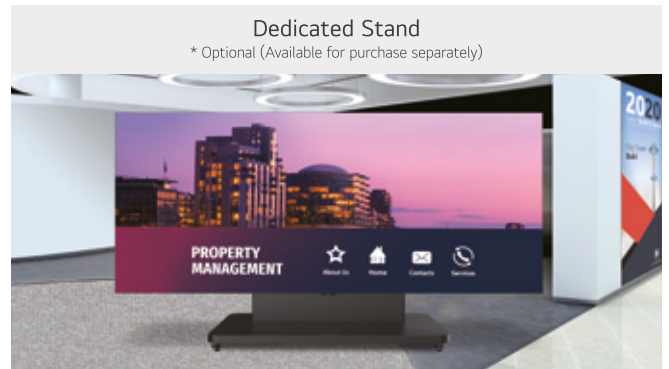

Versatile Installation with Dedicated Accessories

The product is offered with the necessary component including the landscape wall mount and tools for installation. The dedicated stand* is provided as an option, so that you can easily place it depending on your installation sites.

* Stand accessories need to be purchased separately.

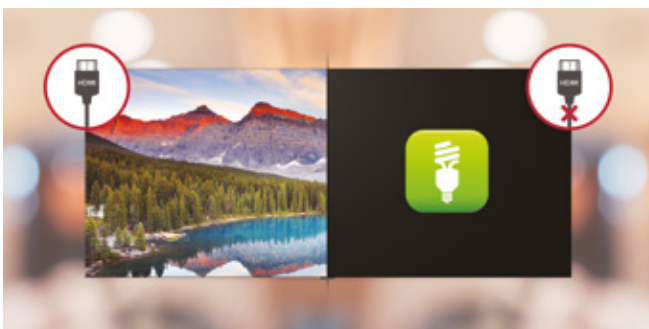

Display Power Management (DPM)

The DPM function of the LED screen allows it to enter a standby mode after a specific period of time when there is no signal from the input source device.

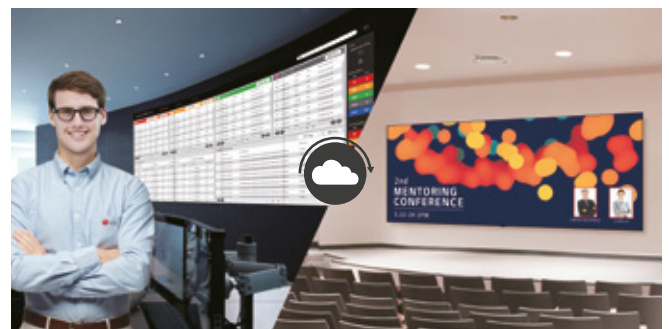

Real-time LG ConnectedCare

Maintenance is easy and fast with the optional LG ConnectedCare* service, a cloud service solution provided by LG. It remotely manages the status of displays in client workplaces for fault diagnosis and remote-control services, enabling the stable operation of clients' businesses.

* The availability of LG ConnectedCare differs by region.

** LG ConnectedCare Service needs to be purchased separately, and available on the basis of internet connection.

SPECIFICATIONS

LAED015-GN

Physical Parameters	Pixel Configuration	Single SMD
	Pixel Pitch (mm)	1.56
	Screen Resolution	2,560 × 1,080
	Module Dimensions (W × H, mm)	250 × 281.25
	No. of Modules per Screen (W × H)	16 × 6 (Total 96)
	Screen Dimensions (W × H × D, mm, including bezel)	4,003.3 × 1,691.8 × 36.5 (Thickest 70)
	Screen Surface Area (m ²)	6.8
	Screen Weight (kg)	176
	Physical Pixel Density (pixels/m ²)	409,600
	Flatness of Cabinet (mm)	±0.2
	Cabinet Material	Aluminum
Service Access	Front	
Optical Specifications	Max. Brightness (nit, after calibration)	500
	Color Temperature (K)	3,200-9,300
	Visual Viewing Angle (Horizontal)	160
	Visual Viewing Angle (Vertical)	160
	Brightness Uniformity	98%
	Color Uniformity	±0.015 Cx, Cy
	Contrast Ratio	3,000 : 1
	Processing Depth (bit)	16 (HDR10, HDR10 Pro)
Electrical Specifications	Power Consumption (W/Screen, Max.)	2,100
	Power Consumption (W/Screen, Avg.)	840
	Power Consumption (W/m ² , Max.)	311
	Power Consumption (BTU/h/Screen, Max.)	7,165
	Power Consumption (BTU/h/Screen, Avg.)	2,866
	Power Consumption (BTU/h/m ² , Max.)	1,062
	Power Supply (V)	100 to 240
	Frame Rate (Hz)	50 / 60
	Refresh Rate (Hz)	3,960
Operation Specifications	Lifetime (Hours to Half Brightness)	100,000
	Operating Temperature (°C)	0 to +40
	Operating Humidity	10-90% RH
	IP Rating (Front / Rear)	IP30 / IP20
Speaker	Built-in (9 W + 9 W)	
Certification	CE, FCC, ETL, CB	
Environment	RoHS, REACH	
Controller	Embedded	
I/O Port	HDMI (3), DP (1), USB, LAN, RS-232C In/Out, IR, Optical Digital Audio Out	

* Specifications are subject to change without notice. Please make sure to check the product manual for details about product usage.

CONNECTIVITY

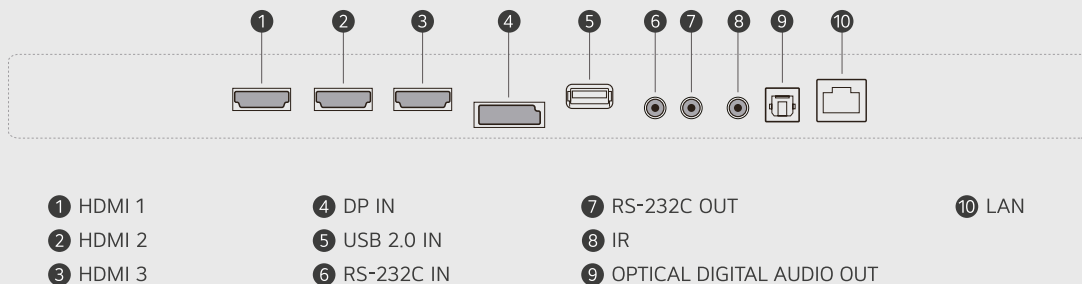

As a continuing policy of product development at LG Electronics, the design and specifications are subject to change. They may vary from model to model. Colour/shades may vary due to printing restrictions. E&OE.